



## BEA ARCHITECTURAL SPECIFICATION SHEET

### Automatic and Industrial Door Solutions: MS08 Touchless Switch

#### Product Specifications

Sensor shall be a hands free activation device designed to detect the motion of a hand and send an electrical signal to the door operator to open the door, re-open or hold a door open. Must be a sensor that operates at 24.125 GHz (K-band frequency). The sensor must have an adjustable range of 4" to 24" (10.16 cm to 60.96 cm).

Touchless Switch specification is based upon the MS08 Microwave Motion Sensor Face Plate Dimensions: 2.77 in. x 4.56 in. (7.0 cm x 11.58 cm) (single gang) and 4.56 in. x 4.56 in. (11.58 cm x 11.58 cm) (double gang).

1. Mounting: Wall mounted within a single gang or double gang electrical conduit box.
2. Thermal Range Requirements: - 4°F (20°C) to 131°F (55°C)
3. Sensor shall be capable of detecting motion from 4 in. to 24 in. (10.16 cm to 61 cm)
4. Sensor shall not detect presence of a stationary object
5. Relay Output Hold Time: 0.5 seconds – 10 Seconds & pulse mode options.
6. Certifications: Electromagnetic compatibility (EMC) according to 2004/108/EC, FCC: G98-MS08, IC: 4680A-MS08.
7. Sensor must be capable of being installed in interior or exterior environments.
8. Four wire conductor, 18 gauge minimum 12-24V AC/DC Power.
9. Finish: Black polycarbonate with white lettering, white polycarbonate with gray lettering or cream colored polycarbonate with gray lettering. Housing: Sensor shall be made of polycarbonate with lettering & graphic (hand wave), and available in black, white or cream colors.

#### Note to Specifier:

10MS08U includes single and double gang black faceplates with wave to open text and (wave) logo

70.5278/70.5279 – single gang and double gang black faceplates with handicapped logo

70.5268/70.5269 – single gang and double gang white faceplates with wave to open text and (wave) logo

#### Product image and Application Photo

BEA Inc.  
RIDC Park West  
100 Enterprise Drive  
Pittsburgh, PA 15275-1213

Phone: 1.800.523.2462  
Fax: 1.888.523.2462



Member  
American Association of  
Automatic Door Manufacturers

A HALMA COMPANY

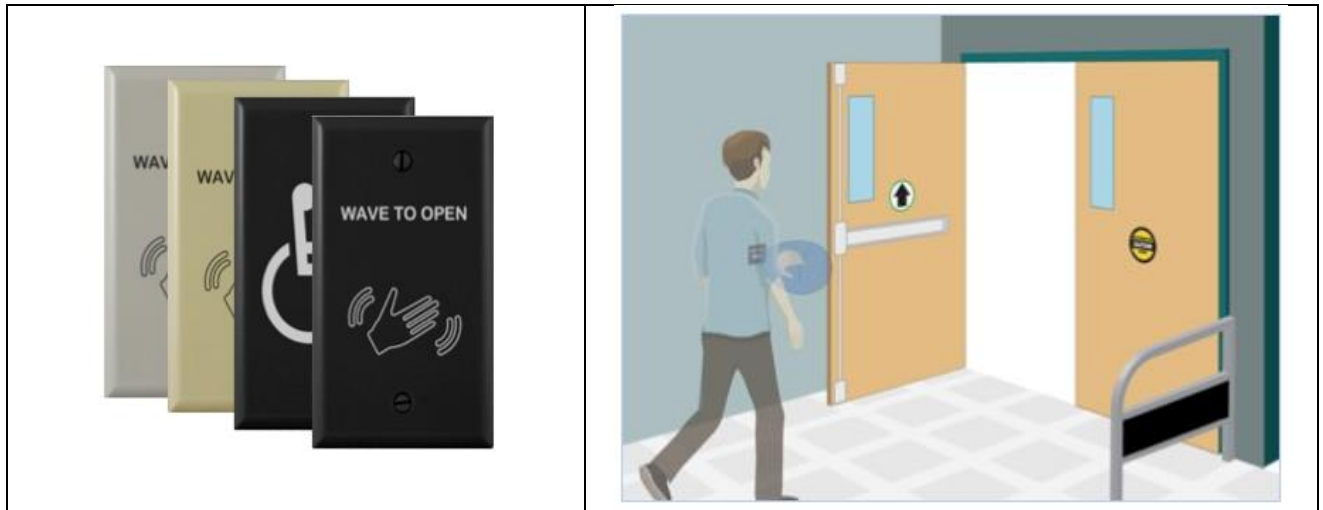

### Technical Specs:

<b>Technology</b> Radiated Frequency Transmitter Radiated Power Radiated Power Density	K-Band Microwave Doppler Radar 24.125 GHz < 20 dBm EIRP < 5 mW/cm <sup>2</sup>
<b>Detection Mode</b>	Motion (bidirectional)
<b>Detection Range</b>	4 in. to 24 in. (10.16 cm to 61 cm) (adjustable)
<b>Output</b> Max. Voltage Max. Current Max. Switching Power	Relay with switch-over contact (free of potential) 60 VDC; 125 VAC 1 A (resistive) 30 W (DC); 60 VA (AC)

<b>Supply Frequency</b>	50 to 60 Hz
<b>Supply Voltage</b>	12 to 24 VAC $\pm$ 10% 12 to 24 VDC + 30%; - 10%
<b>Power Consumption</b>	< 1.2 W
<b>Material / Colors</b>	ASA, Nylon, PC / Black, White, Cream

**BEA Inc.**  
RIDC Park West  
100 Enterprise Drive  
Pittsburgh, PA 15275-1213

Phone: 1.800.523.2462  
Fax: 1.888.523.2462



**AADM** Member  
American Association of  
Automatic Door Manufacturers

A HALMA COMPANY



[www.BEAinc.com](http://www.BEAinc.com)

<b>Output Hold Time</b>	0.5 s (in pulsed mode)

<b>Cable Type</b>	Standard cable up to 16 AWG - 1.5 mm <sup>2</sup>
<b>Temperature Range</b>	-4°F to 131°F (-20°C to 55°C)
<b>Certifications</b>	EMC: 2004 / 108 / EC; FCC: G9B-MS08; IC: 4680A-MS08

## Dimensions:

**BEA Inc.**  
RIDC Park West  
100 Enterprise Drive  
Pittsburgh, PA 15275-1213

Phone: 1.800.523.2462  
Fax: 1.888.523.2462



**AADM** Member  
American Association of  
Automatic Door Manufacturers

A HALMA COMPANY

79.0046.01 20160120



www.BEAinc.com

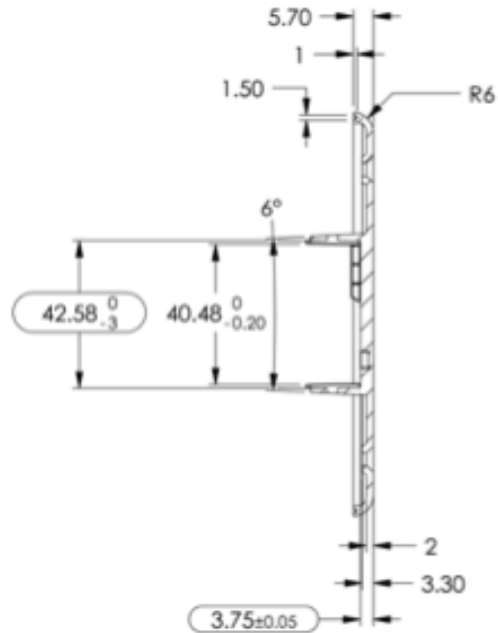
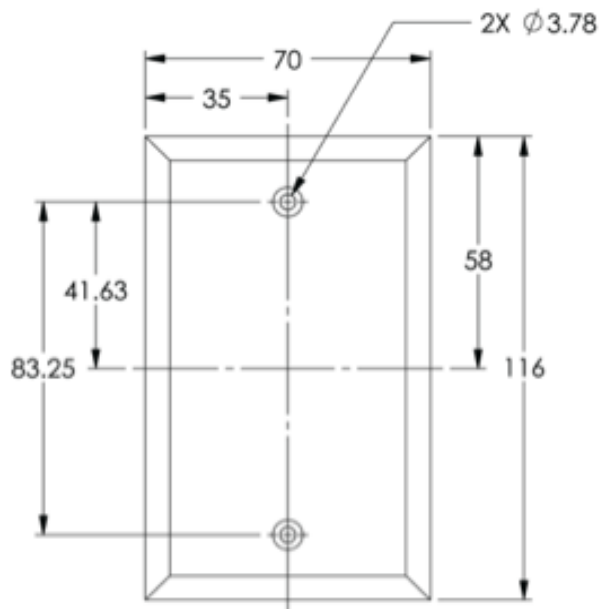

### Double Gang Dimensions:

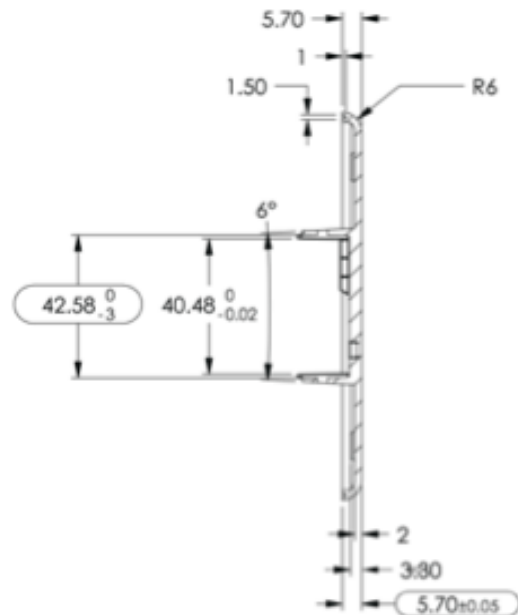
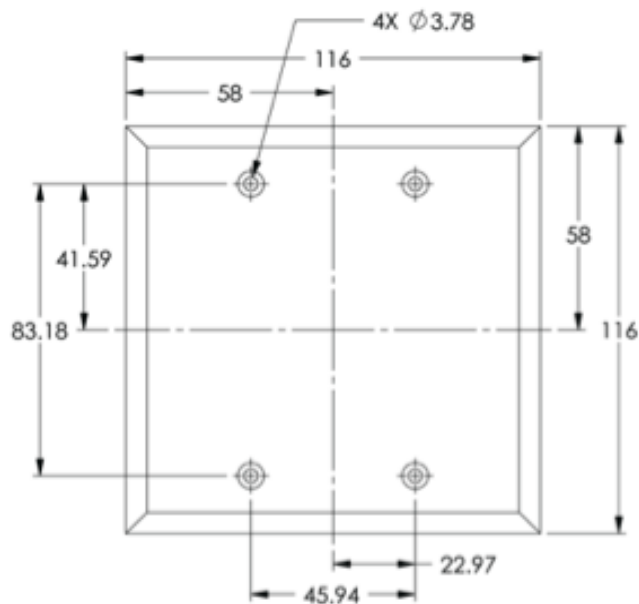

BEA Inc.  
RIDC Park West  
100 Enterprise Drive  
Pittsburgh, PA 15275-1213

Phone: 1.800.523.2462  
Fax: 1.888.523.2462



AADM Member  
American Association of  
Automatic Door Manufacturers

A HALMA COMPANY

79.0046.01 20160120